

# IMPORTANT - PLEASE READ THESE INSTRUCTIONS CAREFULLY BEFORE INSTALLING YOUR OLIVERI MIXER TAP

## Oliveri SS913 Single lever sink mixer with swivel spout



www.oliverisinks.com

**THIS MIXER MUST BE INSTALLED BY A LICENSED PLUMBER IN ACCORDANCE WITH LOCAL REGULATIONS**

This Oliveri tap is manufactured to standard AS/NZS3718

**Max operating pressure: 600kPa**

**Min operating pressure: 50kPa**  
(Recommended range 100-500kPa)

**Max hot temperature: 80°C**  
(Recommended 45°C-65°C)

**Where water pressure exceeds 600kPa, a pressure-reducing device is required to be installed. Note that water pressure overnight can reach 150% of the daytime measure.**

## INSTALLATION

Before attempting any work involving main water supply lines, ensure the water supply is shut off.

Stop valves (preferably with filters) must be used when installing your Oliveri mixer to allow isolation. (Not supplied with mixer).

### Mounting

This mixer tap base is already pre-assembled and tested.

**Do not disassemble, as this may void warranty.**

Place washer "3" onto base ring "2" and place mixer tap over the taphole on your Oliveri sink or benchtop, with the lever on the right hand side.

Underneath the sink, place washer "4" onto tie rod "1" and place fixing plate "5" to fit flush with the bottom of the sink. Attach fixing plate "6" onto tie rod "1" and tighten the whole base with fixing nut "7" on tie rod "1".

### Flexible connectors (Tails)

After checking all threads are clean, attach the braided flexible connectors "8" to water supply pipes by hand.

TF135b - SS913 installation instructions

The red marked tail should be connected to the hot water supply line and the blue marked tail should be connected to the cold water supply line. Give each connector a small extra turn (using hand tools) just enough so they will not be undone by hand.

**AVOID OVER-TIGHTENING.**

**WELS 4 star water efficiency rating, 7.5/L per minute.**

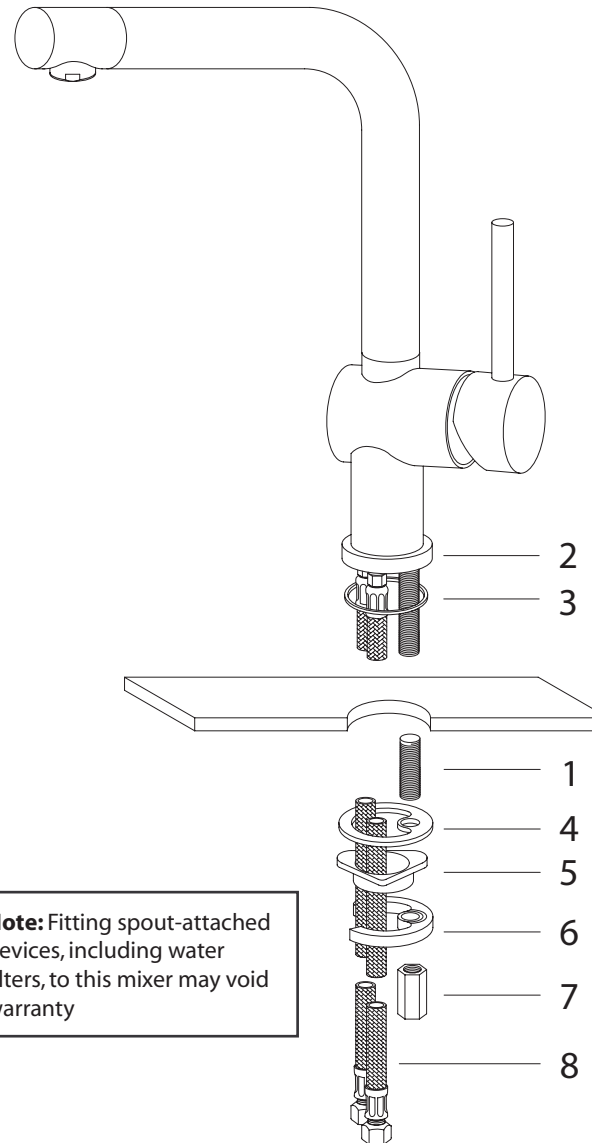

**Note:** Fitting spout-attached devices, including water filters, to this mixer may void warranty

### Water connection

It is essential to the performance of your Oliveri mixer tap that all lines are properly flushed to remove any debris. **Failure to do so may void warranty.** Once clean, connect to hot (red) and cold (blue) water supply lines.

## CARE & MAINTENANCE

The polished chrome-plated finish on your oliveri mixer tap will resist stains and dirt build-up.

Clean with a soft cloth and warm soapy water as necessary - rinse and dry after cleaning. Avoid using abrasive or acid based cleaning products.

## WARRANTY

This mixer tap is warranted to be free from manufacturing defects for a period of 10 Years: 5 years only (parts & labour) plus an additional 5 years on the Cartridge (parts only), when used in a domestic situation.

**This warranty does not cover against normal wear and may be voided if the product is misused or not installed in accordance with these instructions.** Note: Fitting spout-attached devices, including water filters, to this mixer may void warranty.

In the event this product is rendered obsolete and a replacement product is required, Tasman Sinkware reserves the right to supply a product of equal substitution at their discretion.

## SERVICE

**If the problem represents a danger, or damage to property may occur, immediately shut off the water supply.**

If the mixer tap requires servicing, please contact your plumber (preferably the one who installed it).

Most problems occur due to contaminated supply lines or water pressure exceeding 600kPa.

If the Plumber is satisfied that the problem is not due to poor installation, contact T2 Services Pty Ltd for assistance on:

Ph: (07) 5596 0738

Fax: (07) 5527 3353

Email: oliveri@t2services.com.au

**If a warranty service call finds that the mixer tap is not at fault, T2 Services Pty Ltd reserves the right to pass on any callout fee to the householder.**