



Model No:  
**1173U**  
**Professional Series**  
 UNDERMOUNT SINK

www.oliverisinks.com

18/10  
 STAINLESS  
 STEEL

16  
 GAUGE



Model No: **1173U**  
 DIMENSIONS

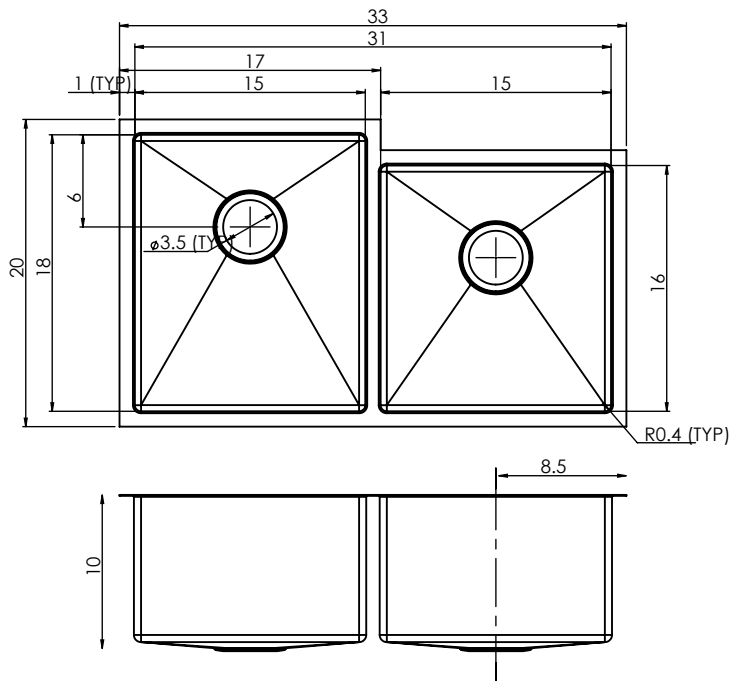

INCLUDED  
 ACCESSORIES

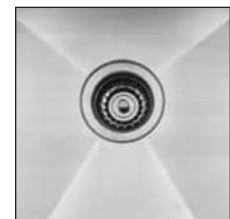

Basket Waste x 2

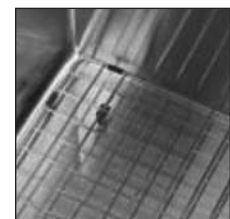

Basin Protectors x 2

<b>MATERIAL</b> Stainless Steel 304 Grade 16 Gauge	<b>CONSTRUCTION</b> Fabricated bowl with 1/2" (10mm) internal radius corners	<b>SHIPPING WEIGHT</b> (Packed) 33lb	<b>INSTALLATION METHOD</b> Designed to be undermounted into a counter	<b>CABINET</b> Minimum 36"
---	---	--	--	----------------------------------



Head Office  
 Tasman Sinkware Pty Ltd  
 51 Naweena Rd, Regency Park  
 South Australia, 501  
 AUSTRALIA

North America  
 1230 Railroad St  
 Corona CA 92882  
 northamerica@oliverisinks.com

This sink is fabricated by a  
 partner supplier according to  
 Tasman Sinkware's specifications  
 and quality standards